

## LEETON MULTIPURPOSE COMMUNITY CENTRE – 3-5 Wade Ave Leeton

### FEE SCHEDULE:

These hire fees support the operational costs of the Centre including electricity, security, ground maintenance, general cleaning, insurance, rates, water, maintenance – pest control, air-conditioning, wear and tear.

| Area  | Use                       | Rate (Inc GST)   |                       |           |
|---|---------------------------|--|-----------------------|-----------|
|   |                           | Community  | Corporate/<br>Private |           |
| Individual Hall (CWA Hall or Gordon Hall)                                 | Weekday – Mon-Fri         | Half day – 4hrs or less  | \$42                  | \$115     |
|   |                           | Full day   | \$62                  | \$155     |
|   | Weekend Sat/Sun           | Half day – 4hrs or less  | \$42                  | \$135     |
|   |                           | Full day   | \$62                  | \$190     |
| Small Meeting Room  | All Times                 | Up to 2 hours  | \$28                  | \$47      |
|   |                           | Half day – 4hrs or less  | \$41                  | \$83      |
|   |                           | Full day   | \$56                  | \$114     |
| Large Kitchen   | All times                 | If used on its own (rate depends on stated use)  | \$34-\$55             | \$62-\$88 |
| Combined - Halls (CWA Exhibition & Gordon) , small meeting room & kitchen | Weekday – Mon-Fri         | Half day – 4hrs or less  | \$83                  | \$227     |
|   |                           | Full day   | \$124                 | \$320     |
|   | Weekend Sat/Sun           | Half day – 4hrs or less  | \$83                  | \$289     |
|   |                           | Full day   | \$124                 | \$376     |
| Office Spaces   | Permanent or Casual basis | By Negotiation – considers period of use, size of room, use of the general facility and flexibility to share. Completion of a formal agreement will be required prior to occupation. |                       |           |

**PLEASE NOTE: The above rates apply to users who leave the Centre in a clean and tidy state. Additional cleaning charges will be applied should it be warranted.**

## MEMBERSHIP RATES:

### Community Membership

#### Becoming an annual member means:

- Access to the facility at discounted rates (up to a maximum level)
- Having free access to the main kitchen whenever needed
- Being able to view, make and amend bookings via the online booking system
- Having the option to use a community storage space if required (an additional charge applies)

#### The conditions for membership are:

- Memberships require annual payment upfront and commence each year from 1st March. Those who seek membership after this date will be offered a pro-rata rate based on the months remaining up to the following 1st March.
- Memberships entitle the hirer to the booking of one room at the facility within each booking. It does not provide hirers with full access to the facility within each booking. Usage of extra spaces will incur an additional fee.
- Maximum levels of discounted use applies. Any use after the maximum level is reached will be levied at regular community rates.
- There will be no refunds for any hire that is not used.
- A hire agreement outlining the conditions of hire will need to be completed and signed by an authorised representative of the group.

#### Membership Levels and Costs:

All levels will be based on the discounted rates of:

- Small Meeting use (2 hours) @\$10 (normally \$20)
- Half day use (up to 4 hours) @\$20 (normally \$30)
- Full day use @ \$30 (normally \$45)

| Name           | Purpose  | Cost per Year            | What it allows   |
|----------------|--|--------------------------|--|
| Level 1        | This supports groups who hold monthly meetings   | \$135                    | Allows use at the discounted rates up to the membership cost. Hire in excess of this will be at the usual community rates. |
| Level 2        | This supports groups who hold between one to three meetings/workshops in a month                 | \$400                    |  |
| Level 3        | This supports groups who hold regular weekly group gatherings                                    | \$790                    |  |
| Storage Spaces | Individual locked storage is available for a reasonable amount of items in regular use by groups | Small \$60<br>Large \$80 | Allows items to be stored on site*   |

\* Please Note: Individual storage will be allocated on a "first in" basis until capacity is reached. Items for storage should be those that are crucial to the operation of the group's activities. It is not the intention that this space be used as an archive facility or a home for seldom used equipment.

## Corporate/Private Membership

Special rates can be negotiated for corporate and private business looking to hire the multipurpose areas on multiple occasions i.e. 6 times per year or more.

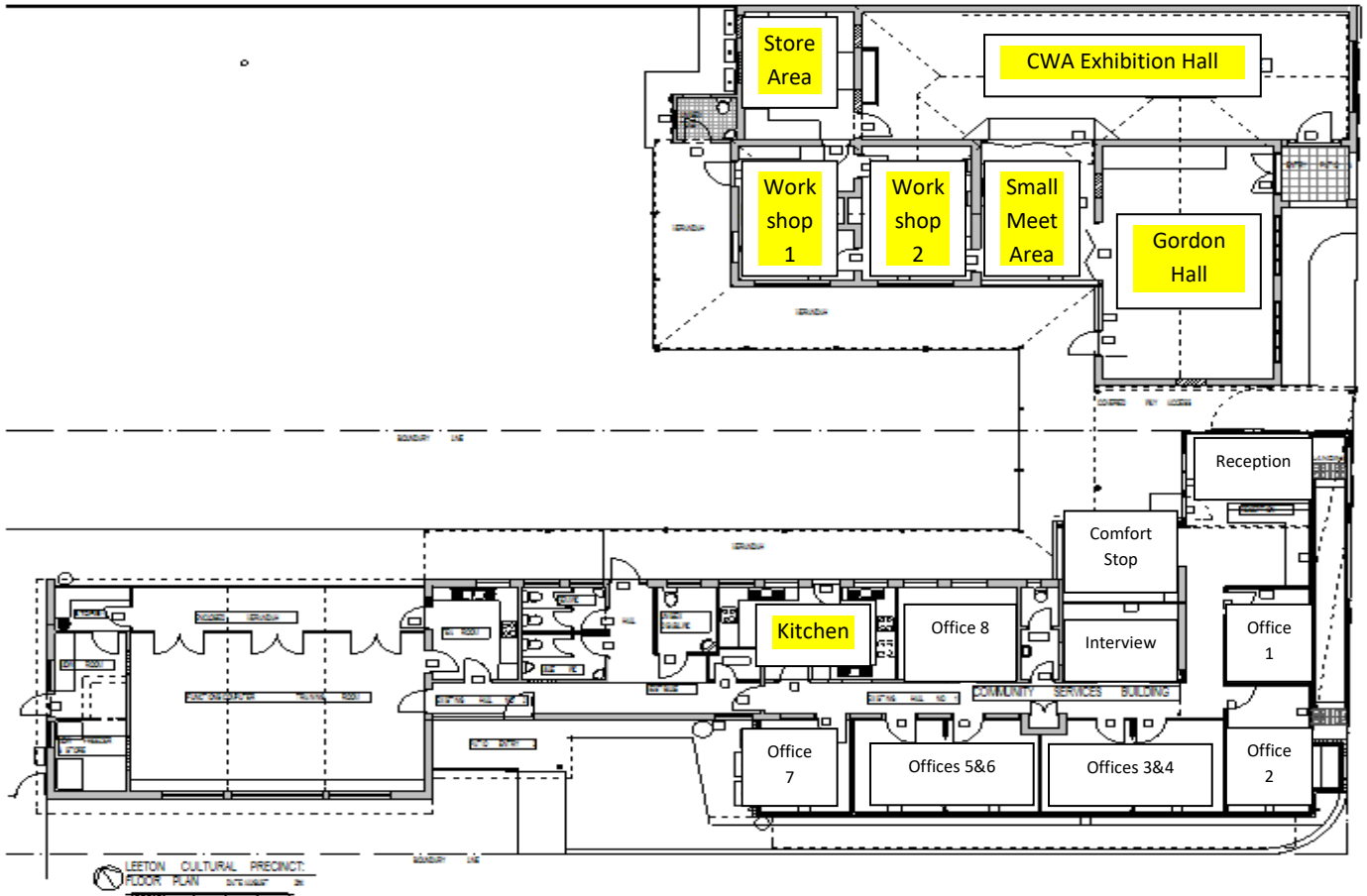

Leeton Shire Council  
23-25 Chelmsford Place, Leeton, NSW, 2705  
Phone: 6953 0911  
Email: [council@leeton.nsw.gov.au](mailto:council@leeton.nsw.gov.au)